

机型 Model	737-300	飞机注册号 A/C Reg	5N-MJA	颁发部门 Issue	培训部	修订日期 Revised Date	2020.07.20
区域 Zone	驾驶舱	依据文件 Reference	AMM21-33-07	版本 Rev	R0	预计工时 Est. MHrs	4H
编写/修订 Edited By	葛荣文	审核/日期 Review/Date	谈海军 /2020.08.04	审批/日期 Approve/Data	张玉/2020.08.05		

标 题: 拆装客舱高度压差指示器**SUBJECT: CABIN ALTITUDE/DIFFERENTIAL PRESSURE INDICATOR - REMOVAL/INSTALLATION****说明/Comments:**

客舱高度/压差指示器位于前头顶面板右下角 P5-16 面板。

The cabin altitude/differential pressure indicator is located in the P5-16 module on the lower right part of the forward overhead panel.

工卡中加*的步骤, 实施时由学员在驾驶舱和工作区域口述以及演示工作步骤。

The steps of adding*to the work card are narrated and demonstrated by the trainees in the cockpit and work area during the implementation.

计划信息/Planning Information**A.参考资料/References**

Reference	Title	Remark
N/A	N/A	N/A

B.航材/Expendable Part

FIG.ITEM	IPC-Ref	Part Name	P/N	QTY	Remark
N/A	N/A	N/A	N/A	N/A	N/A

C.工具设备/Tool Equipment

Reference	Description	QTY	Remark
N/A	十字螺丝刀	1	或等效工具
N/A	11/16 开口扳手	1	或等效工具
N/A	插头钳	1	或等效工具
N/A	反光背心	AR	N/A

D.消耗品/Consumable Material

Reference	Description	Specification	QTY	Remark
N/A	插头清洁剂	N/A	1	N/A
N/A	保护袋	N/A	AR	或等效耗材
N/A	抹布	N/A	AR	N/A
N/A	线手套	N/A	AR	N/A

工 作 内 容 CONTENTS	工作者 MECHANIC
<p>1. 概述 General</p> <p>本程序有如下工作:</p> <p>This procedure has these tasks:</p> <ul style="list-style-type: none"> ● 拆除客舱高度/压差指示器 Cabin Altitude/Differential Pressure Indicator Removal ● 安装客舱高度/压差指示器 Cabin Altitude/Differential Pressure Indicator Installation 	
<p>任务 TASK 21-33-07-004-001</p> <p>2. 拆除客舱高度/压差指示器 Cabin Altitude/Differential Pressure Indicator Removal</p> <p>(1) 接近位于前头顶面板右下角P5-16面板的客舱高度/压差指示器。 Gain access to the cabin altitude/differential pressure indicator on the P5-16 module on the forward overhead panel.</p> <p>(2) 松开把指示器紧紧的固定在卡子里的两个螺钉。 Loosen the two screws that hold the indicator tightly in the clamp.</p> <p>注 意：不必松开把卡子固定在面板上的两个螺钉。 NOTE: You do not have to loosen the two screws that hold the clamp to the panel.</p> <p>(3) 从面板上拆除客舱高度/压差指示器。 Remove the cabin altimeter/differential pressure indicator from the panel.</p> <p>(4) 拆下指示器的电插头。 Remove the electrical connector from the indicator.</p> <p>(5) 从快卸接头处断开静压软管。 Disconnect the static pressure hose from the quick-disconnect.</p> <p>(6) 从客舱高度/压差指示器上拆下快卸接头和封圈。 Remove the quick-disconnect and the packing from the cabin altitude and differential pressure indicator.</p> <p>(7) 报废封圈。 Discard the packing.</p> <p>注 意：如果客舱高度/压差指示器可以使用并将重新安装在P5-16面板上，则不要拆卸快卸接头和封圈。 NOTE: If the cabin altitude and differential pressure indicator is serviceable and will be reinstalled in the P5-16 module, do not remove the quick-disconnect fitting and packing.</p> <p>(8) 在客舱压力孔上安装保护帽，以防止外来物进入。 Put a protective cap on the cabin pressure port to keep out unwanted objects.</p>	

工 作 内 容 CONTENTS	工作者 MECHANIC
<p>(9) 检查客舱高度/差压指示器, 确保状态良好 Do the check of the cabin altitude and differential pressure indicator and make sure it in good state.</p>	
<p>任务 TASK 21-33-07-404-009</p> <p>3. 安装客舱高度/压差指示器 Cabin Altitude/Differential Pressure Indicator Installation</p> <p>A. 步骤 Procedure</p> <p>(1) 在快卸接头[2]上安装密封圈[3]。 Put a packing [3] on the quick-disconnect [2].</p> <p>(2) 将快卸接头[2]安装在客舱高度/差压指示器[6]上。 Install the quick-disconnect [2] on the cabin altitude and differential pressure indicator [6].</p> <p>(3) 将静压软管连接到快卸接头[2]上。 Connect the static pressure hose to the quick-disconnect [2].</p> <p>(4) 将电插头连接到客舱高度/压差指示器[6]上。 Connect the electrical connector to the cabin altitude/differential pressure indicator [6].</p> <p>(5) 取下客舱高度/压差指示器[6]背后的客舱压力口上的保护帽。 Remove the protective cap from the cabin pressure port on the back of the cabin altitude/differential pressure indicator [6].</p> <p>(6) 将客舱高度/压差指示器[6]置于P5-16面板的安装位置。 Put the cabin altitude/differential pressure indicator [6] in its installed position in the P5-16 module.</p> <p>(7) 将两个螺钉拧紧。 Tighten the two screws.</p> <p>B. <u>*客舱高度/压差指示器测试</u> <u>Cabin Altitude/Differential Pressure Indicator Test.</u></p> <p>(1) 对客舱高度/压差指示器进行测试(任务34-12-01-735-086)。 Perform a test of the Cabin Altitude/Differential Pressure Indicator (Air Data System - System Test, TASK 34-12-01-735-086).</p>	
<p>4. 收尾Close-Out :</p> <p>(1) 作业区域整理清洁。 Keep the working area clean and tidy.</p> <p>(2) 设施、设备归还到位。 Return the facilities and equipment back.</p>	

实作工卡

JOB CARD

工卡号
JC No.

M8-028

工 作 内 容 CONTENTS	工作者 MECHANIC
<p>(3) 构型要恢复正常 。 Restore to the normal configuration.</p> <p>(4) 落实三清点。 Implement the three checks.</p> <p>(5) 维修记录签署完成 。 Complete the signature of maintenance record.</p> <p>----- END OF TASK -----</p>	

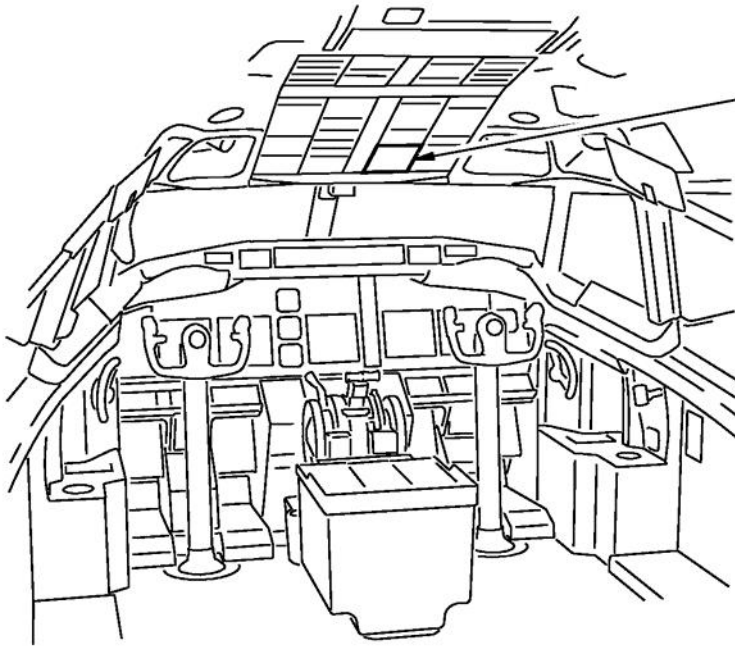

CABIN PRESSURE CONTROL PANEL

SEE (A)

FLIGHT COMPARTMENT

CABIN ALTITUDE AND DIFFERENTIAL PRESSURE INDICATOR

SEE (B)

1. CLAMP TENSION SCREW

1. CLAMP TENSION SCREW

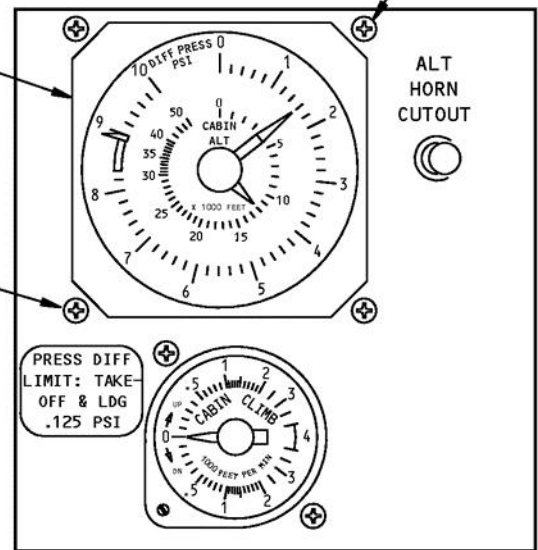

CABIN PRESSURE CONTROL PANEL (P5-16)

(A)

E63818 S00041206436_V1

Cabin Altitude/Differential Pressure Indicator Installation

Figure 401 (Sheet 1 of 2)/21-33-07-990-801

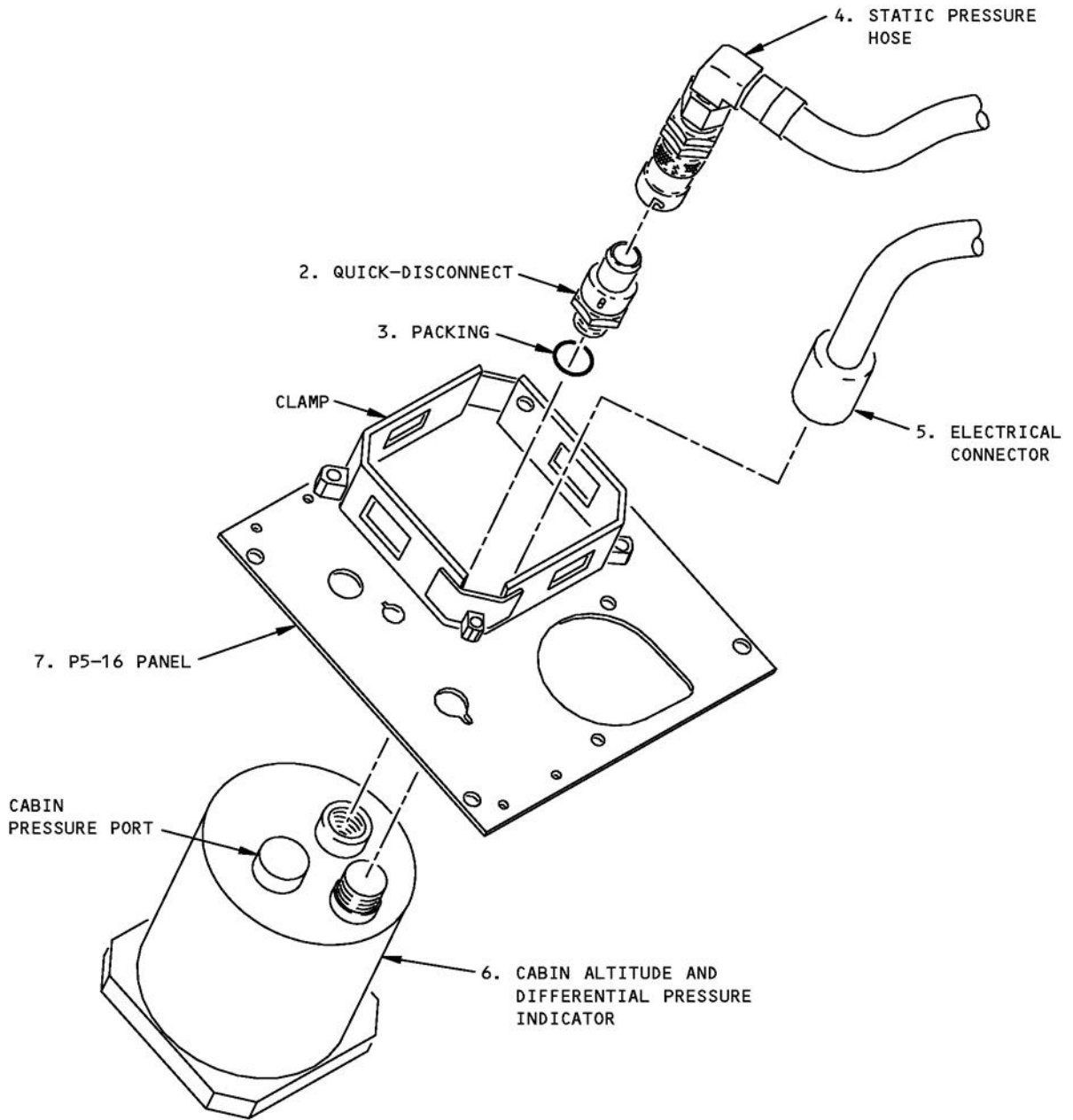

CABIN ALTITUDE AND DIFFERENTIAL PRESSURE INDICATOR

(B)

J37622 S00041206437_V2

Cabin Altitude/Differential Pressure Indicator Installation

Figure 401 (Sheet 2 of 2)/21-33-07-990-801